

CERTIFIED LAND CORNER RECORDATION

DESCRIPTION OF CORNER EVIDENCE FOUND, AND ORIGINAL RECORD (If known)

1/4 corner 36 ³¹/₃₀ T.15 N., 6th P.M., Laramie County, Wyoming
 R.63W R.62W.

Found 3/4" iron pipe in County Road 15-HI, set 1 foot deep.

DESCRIPTION OF MONUMENT AND ACCESSORIES ESTABLISHED
 TO PERPETUATE THE ORIGINAL LOCATION OF THIS CORNER:

Set 5/8" x 18" rebars with Surv-kaps northeasterly and southeasterly. (See sketch)
 Stamped 'WITNESS CORNER'.

SKETCH, WITH COURSE AND DISTANCE TO ADJACENT CORNER IF DETERMINED IN THIS SURVEY.
 (May Sketch or Paste Reproduction on Reverse Side.)

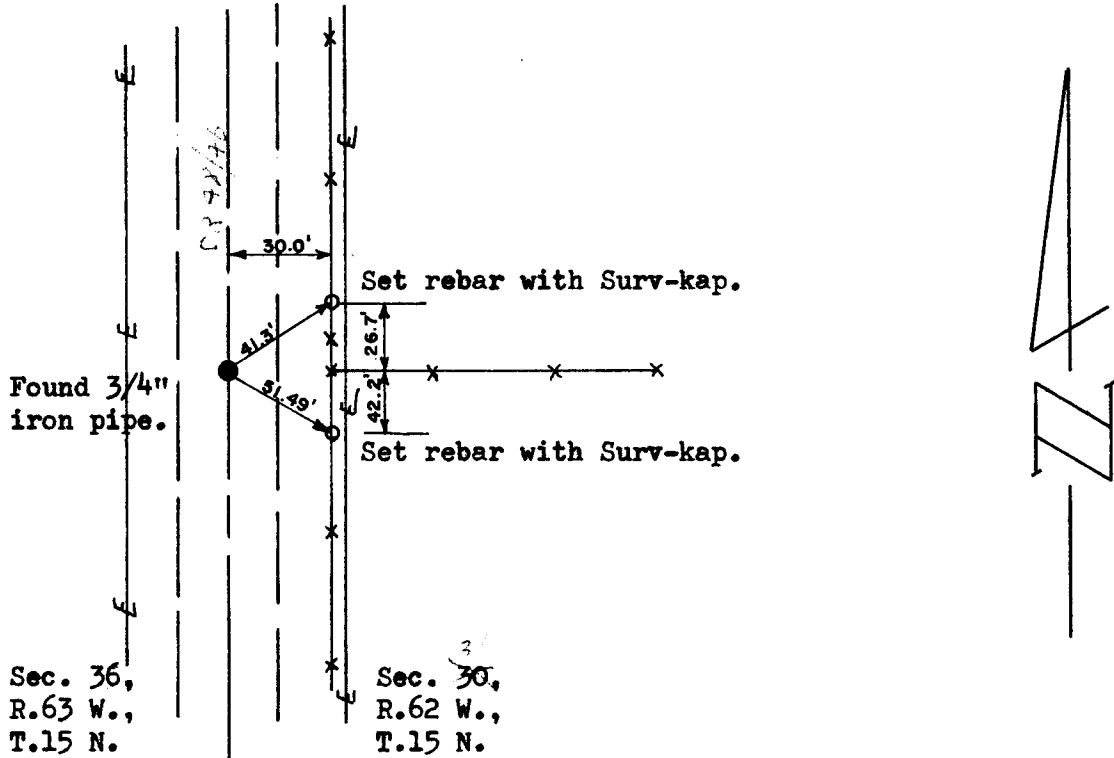

I, William D. Braman certify that I have carefully performed or reviewed the work done on the diagrammed corner as reported on this recordation form and approve the same.

William D. Braman 65566
 Signature of Surveyor Registration No.

STATE OF WYOMING,
 Office of Clerk and Recorder,
 County of Laramie

This "corner record" was filed for record on the 18 day of Feb., 1977, was noted on the cross-index plat and is assigned page No. _____, in book No. _____.

James C. Whitehead
 County Official

| | | | |
|-----------------------|--------------|--------------|------------|
| Cross Index No. _____ | T. _____ | R. _____ | Mer. _____ |
| <u>V-25</u> | T. <u>15</u> | R. <u>63</u> | Mer. _____ |
| <u>V-1</u> | T. <u>15</u> | R. <u>63</u> | Mer. _____ |
| _____ | T. _____ | R. _____ | Mer. _____ |
| _____ | T. _____ | R. _____ | Mer. _____ |
| _____ | T. _____ | R. _____ | Mer. _____ |
| _____ | T. _____ | R. _____ | Mer. _____ |